

APPENDIX D
MONITORING WELL ELEVATION SURVEYOR MEASUREMENTS

AS-BUILT SURVEY

ELEVATION CHART LINCOLN PARK COMPLEX FORT LAUDERDALE, FLORIDA

MW No.	FIELD BOOK/PAGE 2569 / 40-61 SURVEY RESULTS 02-21-2007 Top of Casing Elevation (ft)	FIELD BOOK/PAGE 2666 / 06-22 SURVEY RESULTS 07-10-2008 Top of Casing Elevation (ft)
MW-1	9.60	Destroyed
MW-2	7.61	Destroyed
MW-1r	N/A	10.57
MW-2r	N/A	7.84
MW-3	9.13	9.14
MW-4	9.48	9.50
MW-5	16.69	16.70
MW-6	8.97	8.99
MW-7R	7.72	7.72
MW-8	8.72	8.72
MW-9	6.67	Destroyed
MW-9r	N/A	6.64
MW-10	8.22	8.22
MW-11	N/A	10.23
MW-12	N/A	7.03
MW-13	N/A	7.17
MW-14	N/A	8.51
MW-15	N/A	6.43
MW-16	N/A	6.03
MW-17	N/A	10.83
MW-18	N/A	5.83
MW-19	N/A	6.10
MW-DEP-1	N/A	5.94
MW-DEP-5	N/A	7.70
MW-DEP-10	N/A	5.04
MW-UST-E	9.68	9.70
MW-UST-W	N/A	9.70
LPCGW-11	10.92	10.91
LPCGW-12-R	6.04	6.03
LPCGW-13	11.94	11.86
LPCGW-14	11.75	11.73
LPCGW-15	12.73	12.71
LPCGW-16	9.98	10.40
LPCGW-17	13.35	13.31
LPCGW-18	5.75	5.75
LPCGW-19	5.70	5.68
LPCGW-20	6.98	6.97

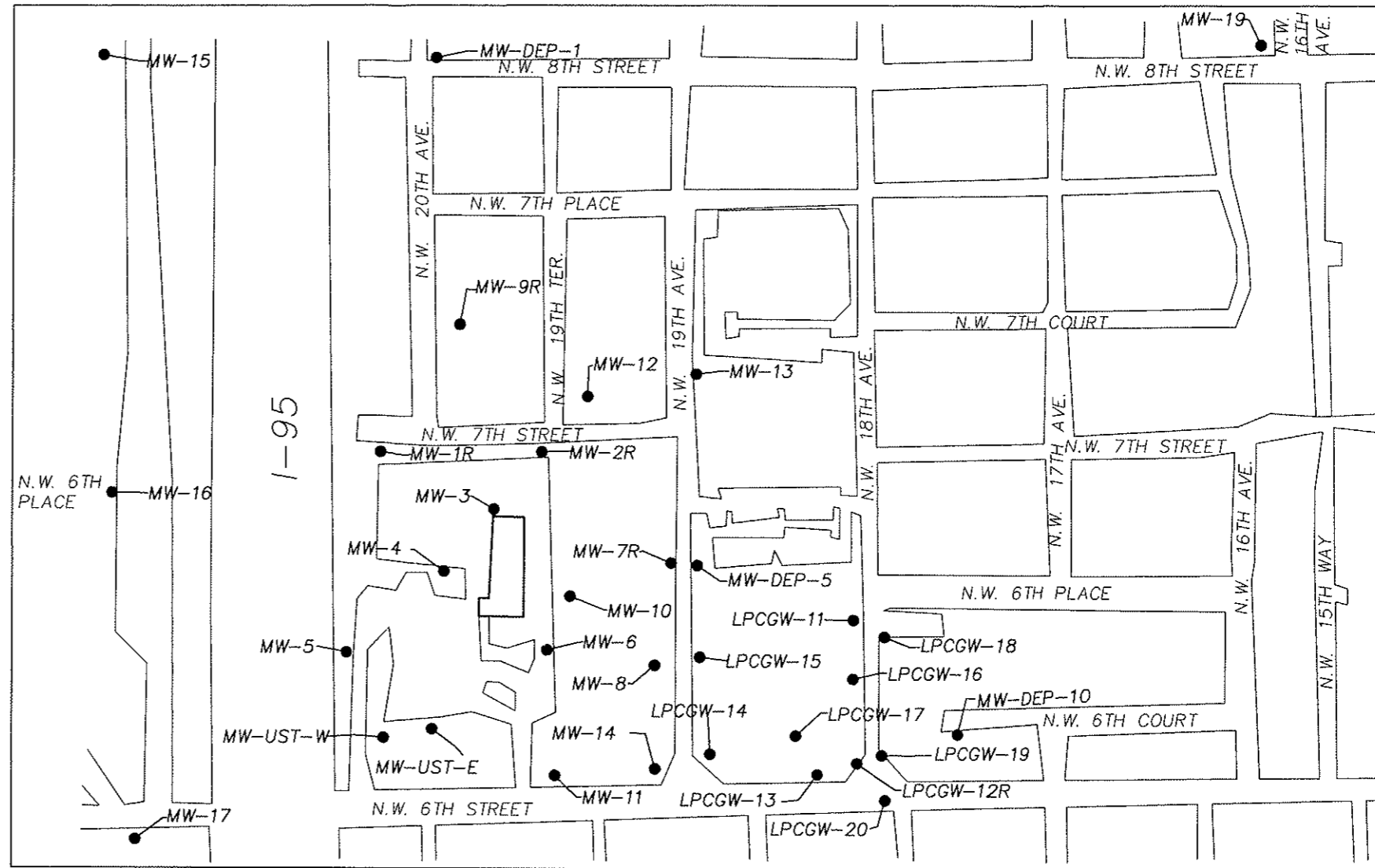

SITE LOCATION
NOT TO SCALE

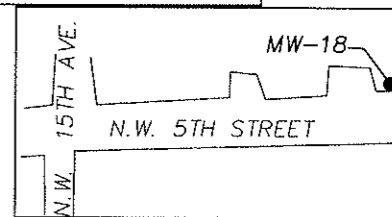

SURVEYOR'S CERTIFICATE:

I hereby certify that the attached "AS-BUILT SURVEY" was prepared in accordance with the Minimum Technical Standards for Surveying & Mapping, Chapter 61G17-6, as set forth by The Florida Board of Surveyors and Mappers, pursuant to Section 472.027, Florida Statutes.

Not valid without the signature and original raised seal of a Florida Licensed Surveyor and Mapper.

Biscayne Engineering Company, Inc.
529 West Flagler Street, Miami, FL 33130
(305) 324-7671
State of Florida Department of Business and Professional Regulation
EB-0000129 LB-0000129

SURVEY DATE: 07-10-2008

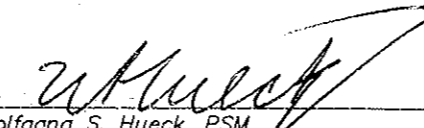
Wolfgang S. Hueck, PSM,
Professional Surveyor and Mapper No. 6519
State of Florida

SURVEYOR'S NOTES:

1. THE SPECIFIC PURPOSE OF THIS AS-BUILT SURVEY IS TO DEPICT CASING ELEVATIONS OF EXISTING MONITORING WELLS AT "LINCOLN PARK COMPLEX".
2. THE IDENTIFICATION OF THE MONITORING WELLS WAS PROVIDED BY CLIENT ON A FIELD INSPECTION BETWEEN E.E.G. AND BISCAIYNE ENGINEERING ON 07-03-2008.
3. WHEN EVALUATING ELEVATION DATA ON THE ATTACHED TABLE, CLIENT SHOULD CONFIRM THAT THE WELL IDENTIFICATION AGREES WITH THEIR UNDERSTANDING OF THE GEOGRAPHIC LOCATION OF THE WELL DEPICTED ON THE ATTACHED SITE LOCATION.
4. ELEVATIONS SHOWN HEREON ARE IN US SURVEY FEET, BASED ON NATIONAL GEODETIC VERTICAL DATUM OF 1929 (NGVD-29), AND ARE REFERENCED TO THE FOLLOWING CITY OF FT. LAUDERDALE BENCHMARKS PROVIDED TO US BY CITY OF FORT LAUDERDALE:

- a) BM NW 24, HAVING AN ELEVATION OF 6.322'
- b) BM NW 25, HAVING AN ELEVATION OF 9.024'.

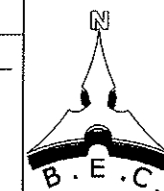

BISCAIYNE ENGINEERING COMPANY, INC.
Consulting Engineers
Planners
Surveyors
E-MAIL: info@biscayneengineering.com
WEB SITE: www.biscayneengineering.com
529 WEST FLAGLER STREET
MIAMI, FL 33130
PH: (305) 324-7671
FAX: (305) 324-0809

LINCOLN PARK COMPLEX
FOR: EVANS ENVIRONMENTAL GEOSCIENCES, LLC
SCALE: N.T.S. DESIGNED BY: W.H. DRAWN BY: W.H. CHECKED BY: W.H.
DATE: 07-10-08 APPROVED BY: W.H. FIELD BOOK No. 2666 PAGE No. 6-22

ORDER No.
03-78254
SHEET No.
1 of 1

/E:\PROJECTS\78000\A\78254 - EVANS ENVIRONMENTAL GEOSCIENCES\orig\78254.dwg 7/17/2008 8:20:41 AM EDT