

MAINTENANCE OF TRAFFIC (MOT) FORM

MOT APPROVAL
CITY OF FORT LAUDERDALE
TRANSPORTATION AND MOBILITY

SECTION 1: APPLICANT INFORMATION

Applicant Name: Riverwalk Fort Lauderdale Applicant Phone: 954-468-1541
Applicant Email: events@goriverwalk.com
Applicant Address: 888 East Las Olas Blvd., Suite 210, Fort Lauderdale, FL 33301
(Address, City, State, Zip Code)
City Project Manager (if applicable): _____ Phone: _____
Agency responsible for this project: City County FDOT Other: Riverwalk Fort Lauderdale
On-site/Emergency Contact Phone: 786-327-3529

SECTION 2: PROJECT INFORMATION

GMOT Permit # (obtain from Department of Sustainable Development (DSD)): Special Event
Project Name: Riverwalk International Food Festival - Special Event
Project Address: Esplanade Park - 400 SW 2nd St., Fort Lauderdale, FL 33301
(Address, City, State, Zip Code)

Specific Dates and Times Requested for MOT Implementation:

Please identify a start date that is at least two weeks from the submittal date. The approval of an MOT application may require up to two weeks from the time that all required documents are received by TAM staff.

Begin Date: 03/22/25 Begin Time: 7:00am
End Date: 03/22/25 End Time: 7:00pm

SECTION 3: PROJECT DETAILS

Partial Closure
 Full Road Closure (detour): Under 72 Hours
 Sidewalk Closure: Under 72 Hours
 Full Road/Sidewalk Closure: More than 72 Hours
Daily Setup/ Breakdown YES NO
Using Crane in ROW* YES NO
Parking Meters Impacted* YES NO
**Crane and parking meter mitigation must be done prior to MOT approval.*

SECTION 4: TYPE OF WORK DESCRIPTION

Please make sure to include the following information in the description:

- List the names of affected streets and the nearest intersection. Use complete street names, including directionals.
- Describe the nature of the construction and any phasing plans. A separate MOT application is required for each phase.
- Describe any specific safety hazards that the work may produce during construction (i.e., large holes, etc.).

SW 2nd St between SW 4th Ave and SW 5th Ave, and SW 4th Ave between SW 2nd St and the New River.
Special event, Riverwalk International Food Festival by Riverwalk Fort Lauderdale. Food trucks and vendors on street in parking spaces.

SECTION 5: FDOT DESIGN STANDARD INDEX DRAWING NUMBERS/MUTCD TYPICAL APPLICATION

(State which FDOT Standard Index 600 series will be followed. The indexes must include the north arrow and the names of the main and cross streets. Also, state whether trenches will be covered or backfilled during non-working hours.)

TA-20

MAINTENANCE OF TRAFFIC (MOT) FORM

MOT APPROVAL

CITY OF FORT LAUDERDALE TRANSPORTATION AND MOBILITY

SECTION 6: MOT DESCRIPTION

Please make sure to include the following information in the description:

- List the lanes that will be open and closed on each street and describe any necessary detours in detail. If detours are not required, please state that below.
- State if flagmen will be provided.
- State if the MOT will be continuous or intermittent. If intermittent, state the times of the day the MOT will be in effect.
- State any other special considerations related to this request.

SW 2nd St. will be closed between SW 4th Ave. and SW 5th Ave.

SW 4th Ave. will be closed between SW 2nd St. & the New River.

SW 5 Ave. will remain open.

MOT will be continuous between 7:00am and 7:00pm on 03/22/25.

SECTION 7: MOT FORM CHECKLIST (Provide one copy of each attachment.)

- | | |
|---|--|
| <input checked="" type="checkbox"/> Completed Required Signatures Form | <input type="checkbox"/> Certification(s) for Traffic Control Technician or Traffic Control Supervisor must be embedded on MOT plans along with FDOT indexes/MUTCD documents |
| <input type="checkbox"/> Color aerial(s)/MOT Plan with index overlay | |
| <input type="checkbox"/> County and State approvals (if required) | |
| <input type="checkbox"/> Crane and Parking Mitigation (if required) | <input checked="" type="checkbox"/> Plan of work (optional, but preferred) |
| <input checked="" type="checkbox"/> FDOT Index MUTCD Reference Drawing(s) | |

SECTION 8: ADDITIONAL COMMENTS

Please Note: The approval of an MOT application may require up to two weeks from the time that all required documents in the checklist above are received by TAM staff. Any rejected MOT submittal that is corrected and sent back will be considered a new submittal, which may require up to two additional weeks to approve. Additional time may be needed for more complex plans or plans requiring additional coordination/information.

In signing this application, I understand that separate City and/or County and/or State permits may be required for this project. Furthermore, I am aware that I am responsible for ensuring that the project is completed in accordance with the plans and specifications as stipulated in the permit approval condition.

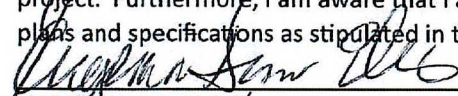
(APPLICANT SIGNATURE)

EUGENIA DUNGEN CEO'S PRES/CEO
(PRINT NAME/TITLE)

01/14/2025
(DATE SIGNED)





As a consideration for the permission granted herein, (APPLICANT) agrees to indemnify and hold harmless the City of Fort Lauderdale for any damages, claims, or injuries that may result from the MOT plan approved under the PERMIT.

(NAME OF COMPANY)

BY: _____
(COMPANY AUTHORIZED AGENT)

REQUIRED SIGNATURES FORM

Applicant must collect all required signatures. To expedite processing, individual signatures may be obtained and submitted to MOT@fortlauderdale.gov separately on this page. All signatures and comments must be submitted before two-week review process begins.

<p style="text-align: center;">M. Ferrer</p> <hr/> <p style="text-align: center;">Print Name</p>	<p style="text-align: center;"></p> <hr/> <p style="text-align: center;">Signature</p>	<p style="text-align: center;">1/15/25</p> <hr/> <p style="text-align: center;">(Date)</p>
<p>Police Department 1300 W. Broward Boulevard Tel: 954-828-5477 <i>Call for Appointment</i></p> <p><i>*Required only if MOT includes a detour for any direction of travel.</i></p>		
<p style="text-align: center;">Katie Williams</p> <hr/> <p style="text-align: center;">Print Name</p>	<p style="text-align: center;"></p> <hr/> <p style="text-align: center;">Signature</p>	<p style="text-align: center;">1/15/25</p> <hr/> <p style="text-align: center;">(Date)</p>
<p>Fire Rescue Department 528 N.W. 2nd Street Tel: 954-828-6864 Email: CBotting@fortlauderdale.gov <i>Call for Appointment</i></p> <p><i>*Required only if MOT includes a detour for any direction of travel.</i></p>		
<hr/> <p style="text-align: center;">Print Name</p>	<hr/> <p style="text-align: center;">Signature</p>	<hr/> <p style="text-align: center;">(Date)</p>
<p>Broward County Traffic Engineering Division 2300 W. Commercial Boulevard Tel: 954-847-2653 <i>Call for appointment. Walk-ins NOT accepted.</i></p> <p><i>*Required only if MOT/detour affects Broward County road or intersection.</i></p>		
<p>After all applicable signatures are collected, applicant should submit the MOT plan and this routing form to the Transportation and Mobility Department at mot@fortlauderdale.gov.</p>		
<p>OFFICE USE ONLY</p>		
<p>Department Director's Signature (requested by City staff if required)</p>		
<p style="text-align: center;">Morgan Dunn</p> <hr/> <p style="text-align: center;">Print Name</p>	<p style="text-align: center;"></p> <hr/> <p style="text-align: center;">Signature</p>	<p style="text-align: center;">1/15/25</p> <hr/> <p style="text-align: center;">(Date)</p>
<p>Transportation and Mobility Department 290 N.E. 3rd Avenue Tel: 954- 828-4997 Email: MOT@fortlauderdale.gov <i>Call for Appointment. Walk-ins NOT accepted.</i></p>		
<p style="text-align: center;"></p> <hr/> <p style="text-align: center;">Signature</p>	<p style="text-align: center;">Transportation and Mobility Department Ben Rogers, Director</p>	<hr/> <p style="text-align: center;">(Date)</p>

A copy of the final permit and this MOT form shall be kept on site and be made available to the City inspector at all times.

Traffic modifications required for special events shall be coordinated through the Parks and Recreation's Special Events Department. Please call 954-828-6075 or email basmith@fortlauderdale.gov.

MOT plans for City Capital Improvement Projects shall be coordinated through the City of Fort Lauderdale Public Works Department. Please call 954-828 -5772 or email ralvarez@fortlauderdale.gov.

**MOT APPROVAL
CITY OF FORT LAUDERDALE
TRANSPORTATION AND MOBILITY**

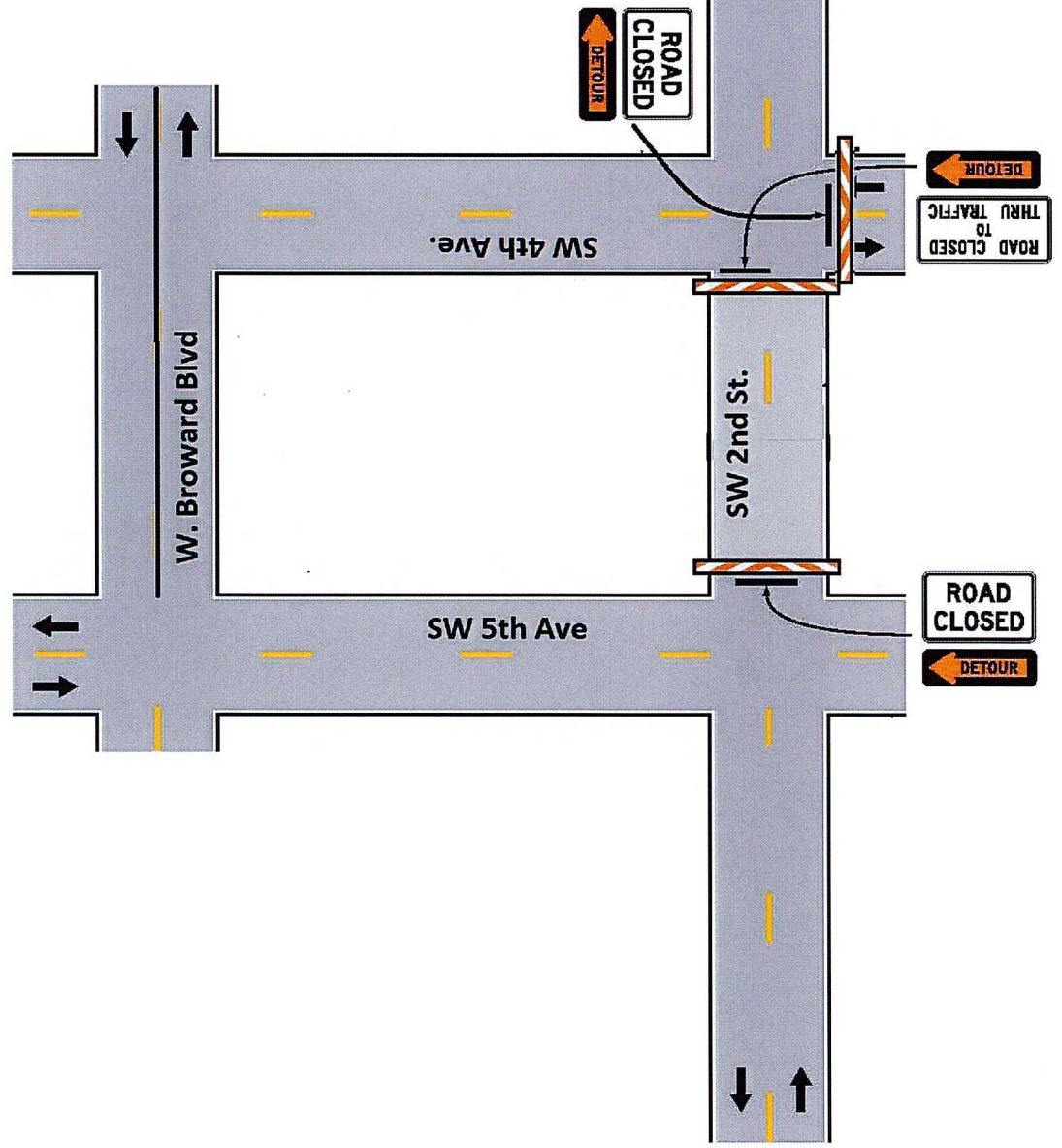

TAM-MOT-25010040 - Riverwalk Food Fest

Final Audit Report

2025-01-21

Created:	2025-01-15
By:	Morgan Dunn (MDunn@fortlauderdale.gov)
Status:	Signed
Transaction ID:	CBJCHBCAABAA8vMOdhT-mlb5_55lqs67PlmnQS3NuDWp

"TAM-MOT-25010040 - Riverwalk Food Fest" History

-  Document created by Morgan Dunn (MDunn@fortlauderdale.gov)
2025-01-15 - 8:56:23 PM GMT
-  Document emailed to Ekaete Ekwere (eekwere@fortlauderdale.gov) for signature
2025-01-15 - 8:56:54 PM GMT
-  Document e-signed by Ekaete Ekwere (eekwere@fortlauderdale.gov)
Signature Date: 2025-01-21 - 3:02:19 PM GMT - Time Source: server
-  Agreement completed.
2025-01-21 - 3:02:19 PM GMT

