

MAINTENANCE OF TRAFFIC (MOT) FORM

MOT APPROVAL
CITY OF FORT LAUDERDALE
TRANSPORTATION AND MOBILITY

SECTION 1: APPLICANT INFORMATION

Applicant Name: Kids In Distress, Inc. Applicant Phone: 954.390.7654 x.1046
Applicant Email: MariaVillavicencio@kidinc.org
Applicant Address: 819 NE 26 Street, Fort Lauderdale, FL 33305
(Address, City, State, Zip Code)
City Project Manager (if applicable): Phone:
Agency responsible for this project: City County FDOT Other: Self & Ft. Lauderdale PD Traffic Officers
On-site/Emergency Contact Phone: 850.980.0044

SECTION 2: PROJECT INFORMATION

ENG Permit # (obtain from Department of Sustainable Development (DSD)): Special Event
Project Name: 19th Annual Duck Fest Derby- Special Event
Project Address: 400 SW 2nd St., Fort Lauderdale, FL 33301
(Address, City, State, Zip Code)

Specific Dates and Times Requested for MOT Implementation:

Please identify a start date that is at least two weeks from the submittal date. The approval of an MOT application may require up to two weeks from the time that all required documents are received by TAM staff.

Begin Date: 4.5.2025 Begin Time: 8am
End Date: 4.5.2025 End Time: 6 pm

SECTION 3: PROJECT DETAILS

Partial or Shoulder Closure
 Full Road Closure (detour): Under 72 Hours
 Sidewalk Closure: Under 72 Hours
 Full Road/Sidewalk Closure: More than 72 Hours
Daily Setup/ Breakdown YES NO
Using Crane in ROW* YES NO
Parking Meters Impacted* YES NO

**Crane and parking meter mitigation must be done prior to MOT approval. Please refer to the MOT Guidelines for crane definitions.*

SECTION 4: TYPE OF WORK DESCRIPTION

Please make sure to include the following information in the description:

- List the names of affected streets and the nearest intersection. Use complete street names, including directionals.
 - Describe the nature of the construction and any phasing plans. A separate MOT application is required for each phase.
 - Describe any specific safety hazards that the work may produce during construction (i.e., large holes, etc.).
- SW 2nd St between SW 4th Ave and SW 5th Ave, and SW 4th Ave between SW 2nd St and the New River.
SE 2nd Street from SE 5th Ave to SE 4th Ave. - this is used for the Fun Zone which includes bounce houses, food trucks, vendors
SE 4th Ave would be closed from SE 2nd Street to the water. This is used for vendor parking, drop off, etc. We will have someone stationed to allow residents in and out of 4th Ave to SE 2nd and beyond. We pay for all of the parking spots every year.

SECTION 5: FDOT DESIGN STANDARD INDEX DRAWING NUMBERS/MUTCD TYPICAL APPLICATION

(State which FDOT Standard Index 600 series will be followed. The indexes must include the north arrow and the names of the main and cross streets. Also, state whether trenches will be covered or backfilled during non-working hours.)
TA-20

Office Use Only

MOT ID#: _____

ENG Permit#: _____

REQUIRED SIGNATURES FORM

Applicant must collect all required signatures. To expedite processing, individual signatures may be obtained and submitted to MOT@fortlauderdale.gov separately on this page. All signatures and comments must be submitted before two-week review process begins.

MOT APPROVAL
CITY OF FORT LAUDERDALE
TRANSPORTATION AND MOBILITY

CHRIS D. GREGORY

Print Name

[Signature]

Signature

Police Department

1300 W. Broward Boulevard | Tel: 954-828-5477

Call for Appointment

*Required only if MOT includes a detour for any direction of travel.

3/4/25

(Date)

Katie Williams

Print Name

[Signature]

Signature

Fire Rescue Department

528 N.W. 2nd Street | Tel: 954-828-6800

Call for Appointment

*Required only if MOT includes a detour for any direction of travel.

3/10/25

(Date)

Print Name

Signature

Broward County Traffic Engineering Division

2300 W. Commercial Boulevard | Tel: 954-847-2653

Call for Appointment. Walk-ins NOT accepted.

*Required only if MOT/detour affects Broward County road or intersection.

(Date)

After all applicable signatures are collected, applicant should submit the MOT plan and this routing form to the Transportation and Mobility Department at mot@fortlauderdale.gov.

OFFICE USE ONLY

Department Director's Signature (requested by City staff if required)

Morgan Dunn

Print Name

[Signature]

Signature

Transportation and Mobility Department

290 N.E. 3rd Avenue | Tel: 954- 828-4997 | Email: MOT@fortlauderdale.gov

Call for Appointment. Walk-ins and hard copies NOT accepted.

3/31/25

(Date)

Signature

Transportation and Mobility Department

Ben Rogers, Director

(Date)

A copy of the final permit and this MOT form shall be kept on site and be made available to the City inspector at all times.

Traffic modifications required for special events shall be coordinated through the Parks and Recreation's Special Events Department. Please call 954-828-4349 or email BHenry@fortlauderdale.gov.

MOT plans for City Capital Improvement Projects shall be coordinated through the City of Fort Lauderdale Public Works Department. Please call 954-828-5772 or email ralvarez@fortlauderdale.gov.

19th Annual Duck Fest Derby – Saturday, April 5th | 12-3pm



- 10x10 White Tent
- Bounce House
- Food Truck
- KID Tent
- Petting Zoo
- 5ft Duck
- Street Barricade
- Welcome
- Mike Spe Ent
- VID Check-in
- Prize/Lanyard
- Sales
- Water & Beer

NOT APPROVAL
CITY OF FORT LAUDERDALE
TRANSPORTATION AND MOBILITY

Notes for Figure 6H-20—Typical Application 20
Detour for a Closed Street

Guidance:

1. *This plan should be used for streets without posted route numbers.*
2. *On multi-lane streets, Detour signs with an Advance Turn Arrow should be used in advance of a turn.*

Option:

3. Flashing warning lights and/or flags may be used to call attention to the advance warning signs.
4. Flashing warning lights may be used on Type 3 Barricades.
5. Detour signs may be located on the far side of intersections. A Detour sign with an advance arrow may be used in advance of a turn.
6. A Street Name sign may be mounted with the Detour sign. The Street Name sign may be either white on green or black on orange.

Standard:

- 7. When used, the Street Name sign shall be placed above the Detour sign.**

Support:

8. See Figure 6H-9 for the information for detouring a numbered highway.

Figure 6H-20. Detour for a Closed Street (TA-20)

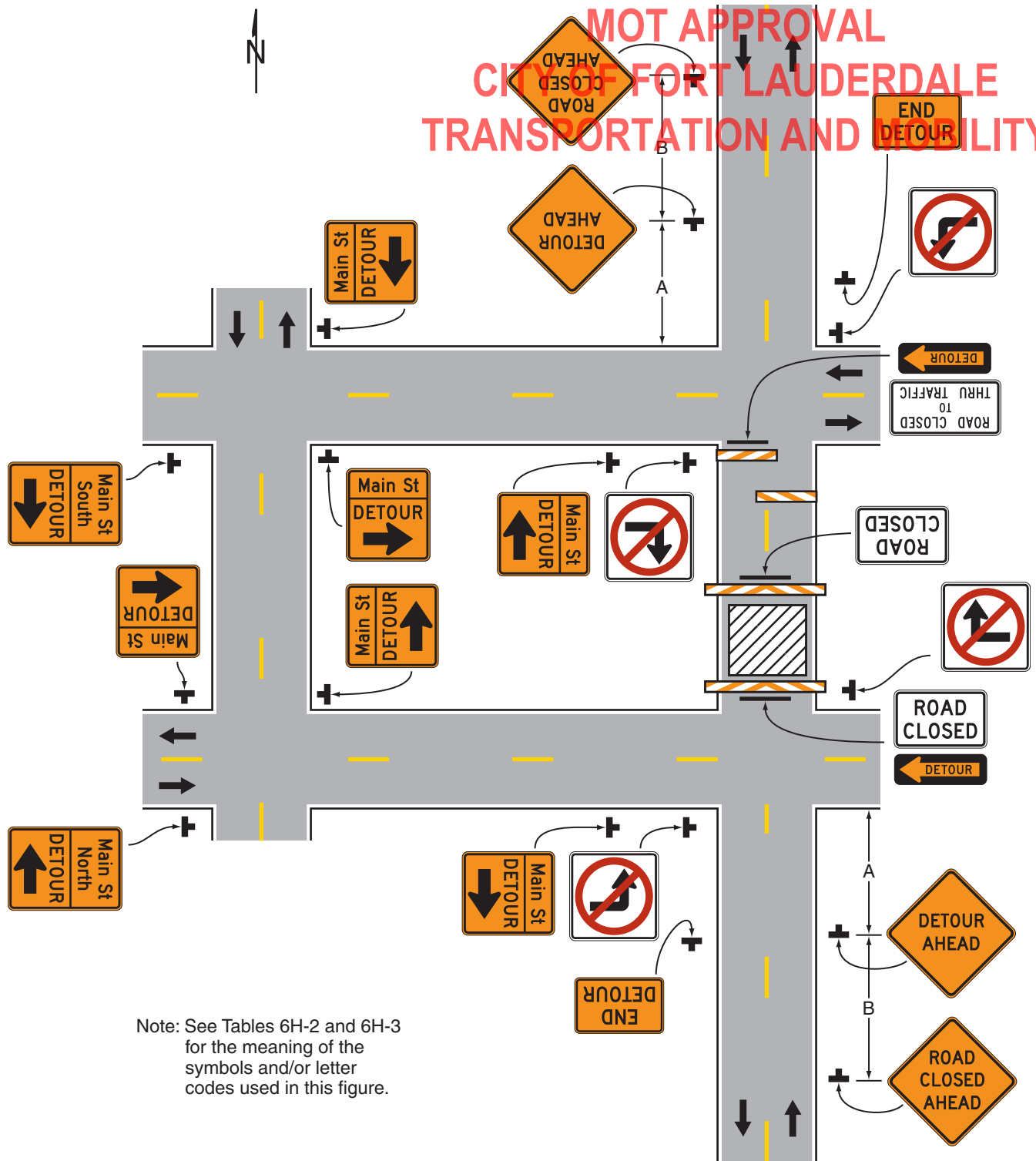

Typical Application 20