



# MAINTENANCE OF TRAFFIC (MOT) FORM

## SECTION 1: APPLICANT INFORMATION

Applicant Name: Ariel Levin Applicant Phone: 407-952-2928  
 Applicant Email: ariel@veganblockparty.com  
 Applicant Address: 9146 Perth Road Lake Worth, Florida 33467  
(Address, City, State, Zip Code)  
 City Project Manager (if applicable): \_\_\_\_\_ Phone: \_\_\_\_\_  
 Agency responsible for this project:  City  County  FDOT  Other: MOT for scheduled event  
 On-site/Emergency Contact Phone: \_\_\_\_\_

## SECTION 2: PROJECT INFORMATION

ENG Permit # (obtain from Department of Sustainable Development (DSD)): N/A - Special Event  
 Project Name: VEGAN BLOCK PARTY (under VEGAN VENTURES, LLC)  
 Project Address: 400 SW 2nd STREET, FORT LAUDERDALE, FLORIDA 33301  
(Address, City, State, Zip Code)

### Specific Dates and Times Requested for MOT Implementation:

Please identify a start date that is at least two weeks from the submittal date. The approval of an MOT application may require up to two weeks from the time that all required documents are received by TAM staff.

Begin Date: 07/05/2025 Begin Time: 4:00am  
 End Date: 07/05/2025 End Time: 12:00am

## SECTION 3: PROJECT DETAILS

Partial or Shoulder Closure  
 Full Road Closure (detour): Under 72 Hours  
 Sidewalk Closure: Under 72 Hours  
 Full Road/Sidewalk Closure: More than 72 Hours

Daily Setup/ Breakdown  YES  NO  
 Using Crane in ROW\*  YES  NO  
 Parking Meters Impacted\*  YES  NO

\*Crane and parking meter mitigation must be done prior to MOT approval. Please refer to the MOT Guidelines for crane definitions.

## SECTION 4: TYPE OF WORK DESCRIPTION

Please make sure to include the following information in the description:

- List the names of affected streets and the nearest intersection. Use complete street names, including directionals.
- Describe the nature of the construction and any phasing plans. A separate MOT application is required for each phase.
- Describe any specific safety hazards that the work may produce during construction (i.e., large holes, etc.).

1) Special Event coordinated by Vegan Ventures LLC at Esplanade Park, 400 SW 2nd Street, Fort Lauderdale, FL 33301  
 2) Not applicable/Not a construction project  
 3) Not applicable/Not a construction project (Please refer to Event MOT plans)

## SECTION 5: FDOT DESIGN STANDARD INDEX DRAWING NUMBERS/MUTCD TYPICAL APPLICATION

(State which FDOT Standard Index 600 series will be followed. The indexes must include the north arrow and the names of the main and cross streets. Also, state whether trenches will be covered or backfilled during non-working hours.)

FDOT Index 102-616  
 (Please refer to Event MOT/Index Packet)



# MAINTENANCE OF TRAFFIC (MOT) FORM

## SECTION 6: MOT DESCRIPTION

Please make sure to include the following information in the description:

- List the lanes that will be open and closed on each street and describe any necessary detours in detail. If detours are not required, please state that below.
- State if flagmen will be provided.
- State if the MOT will be continuous or intermittent. If intermittent, state the times of the day the MOT will be in effect.
- State any other special considerations related to this request.

- 1) Please refer to event MOT plans for open & closed lanes
- 2) Flagmen will not be required; Not a construction project; No conflict with counter-traffic
- 3) MOT will be set up and broken down on the date of the event and will be continuous for the duration of the event (less
- 4) Sidewalk inbetween the park and the road closure is included in the MOT plan.

## SECTION 7: MOT FORM CHECKLIST (Provide one copy of each attachment.)

- Completed Required Signatures Form
- Color aerial(s)/MOT Plan with index overlay
- County and State approvals (if required)
- Crane and Parking Mitigation (if required)
- FDOT Index MUTCD Reference Drawing(s)
- Certification(s) for Traffic Control Technician or Traffic Control Supervisor must be embedded on MOT plans along with FDOT indexes/MUTCD documents
- Plan of work (optional, but preferred)

## SECTION 8: ADDITIONAL COMMENTS

**Please Note: The approval of an MOT application may require up to two weeks from the time that all required documents in the checklist above are received by TAM staff. Any rejected MOT submittal that is corrected and sent back will be considered a new submittal, which may require up to two additional weeks to approve. Additional time may be needed for more complex plans or plans requiring additional coordination/information.**

In signing this application, I understand that separate City and/or County and/or State permits may be required for this project. Furthermore, I am aware that I am responsible for ensuring that the project is completed in accordance with the plans and specifications as stipulated in the permit approval condition.

Ariel Levin  
 (APPLICANT SIGNATURE)  
 6/1/2025  
 (DATE SIGNED)

Ariel Levin  
 (PRINT NAME/TITLE)

As a consideration for the permission granted herein, Ariel Levin (APPLICANT) agrees to indemnify and hold harmless the City of Fort Lauderdale for any damages, claims, or injuries that may result from the MOT plan approved under the PERMIT.

VEGAN VENTURES, LLC.  
 (NAME OF COMPANY)

BY: Ariel Levin  
 (COMPANY AUTHORIZED AGENT)



## REQUIRED SIGNATURES FORM

Applicant must collect all required signatures. To expedite processing, individual signatures may be obtained and submitted to [MOT@fortlauderdale.gov](mailto:MOT@fortlauderdale.gov) separately on this page. All signatures and comments must be submitted before two-week review process begins.

<p><u>M. Ferrer</u> Print Name</p> <p><u>Monica Ferrer</u> Signature</p> <p><b>Police Department</b> 1300 W. Broward Boulevard   Tel: 954-828-5477 <i>Call for Appointment</i></p> <p>*Required only if MOT includes a detour for any direction of travel.</p>	<p><b>MOT APPROVAL</b></p> <p><u>6/24/25</u> (Date)</p>
<p><u>Katie Williams</u> Print Name</p> <p><u>[Signature]</u> Signature</p> <p><b>Fire Rescue Department</b> 528 N.W. 2<sup>nd</sup> Street   Tel: 954-828-6800 <i>Call for Appointment</i></p> <p>*Required only if MOT includes a detour for any direction of travel.</p>	<p><u>6/25/25</u> (Date)</p>
<p>_____ Print Name</p> <p>_____ Signature</p> <p><b>Broward County Traffic Engineering Division</b> 2300 W. Commercial Boulevard   Tel: 954-847-2653 <i>Call for Appointment. Walk-ins NOT accepted.</i></p> <p>*Required only if MOT/detour affects Broward County road or intersection.</p>	<p>_____ (Date)</p>
<p><b>After all applicable signatures are collected, applicant should submit the MOT plan and this routing form to the Transportation and Mobility Department at <a href="mailto:mot@fortlauderdale.gov">mot@fortlauderdale.gov</a>.</b></p>	
<p align="center"><b>OFFICE USE ONLY</b> Department Director's Signature (requested by City staff if required)</p>	
<p><u>Martha Parfait</u> Print Name</p> <p><u>Martha Parfait</u> Signature</p> <p><b>Transportation and Mobility Department</b> 290 N.E. 3<sup>rd</sup> Avenue   Tel: 954- 828-4997   Email: <a href="mailto:MOT@fortlauderdale.gov">MOT@fortlauderdale.gov</a> <i>Call for Appointment. Walk-ins and hard copies NOT accepted.</i></p>	<p><u>7/3/25</u> (Date)</p>
<p>_____ Signature</p> <p><b>Transportation and Mobility Department</b> Ben Rogers, Director</p>	<p>_____ (Date)</p>

A copy of the final permit and this MOT form shall be kept on site and be made available to the City inspector at all times.

Traffic modifications required for special events shall be coordinated through the Parks and Recreation's Special Events Department. Please call 954-828-4349 or email [BHenry@fortlauderdale.gov](mailto:BHenry@fortlauderdale.gov).

MOT plans for City Capital Improvement Projects shall be coordinated through the City of Fort Lauderdale Public Works Department. Please call 954-828-5772 or email [ralvarez@fortlauderdale.gov](mailto:ralvarez@fortlauderdale.gov).

PLAN NOT TO SCALE



W BROWARD BLVD

AVE OF ARTS

SW 5 AVE

SW 4 AVE

NUGENT AVE

SW 2 ST

MARK@MOTPLANS.COM

**FDOT**  
 Mark Meyers  
 Certificate: Has Completed a FDOT Approved Temporary Traffic Control Advanced Course.  
 605769  
 Issued: 02/13/2023 Training Provider: myTTOnline  
 Expires: 02/02/2027 83 Geneva Dr, Ste. 621394  
 Oviedo, FL 32762  
 Instructor: M.H. Ph: 407-601-0206  
 Verify this Certificate at [www.motadmin.com](http://www.motadmin.com).

DRAWN BY MM

MOT Plans

600 ft

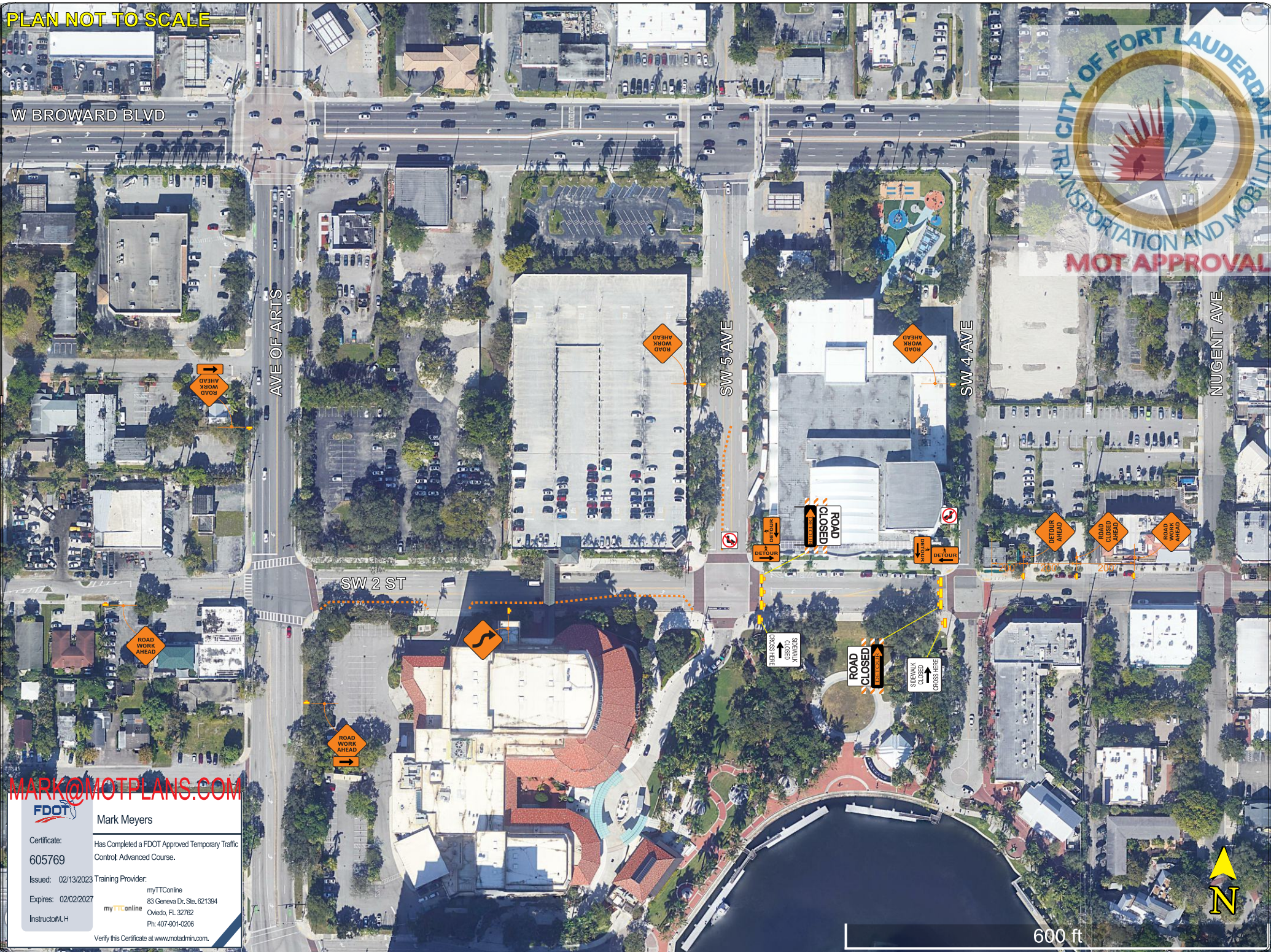



SHEET	TABLE OF CONTENTS
1	General Notes, TTC Tables
2	Definitions Temporary Traffic Control Devices Overhead Work Railroads Sight Distance Above Ground Hazard
3	Clear Zone Widths For Work Zones Superelevation Length Of Lane Closures Overweight/Oversize Vehicles Lane Widths High-Visibility Safety Apparel Speed Reduction Signing
4	Flagger Control Survey Work Zones Signs
5	Work Zone Sign Supports
6	Commonly Used Warning and Regulatory Signs In Work Zones
7	Manholes/Crosswalks/Joints Truck Mounted Attenuators Signals Channelizing Devices Channelizing Devices Consistency Advanced Warning Arrow Boards
8	Drop-Offs In Work Zones
9	Business Entrance Temporary Asphalt Separator
10	Channelizing Devices Notes Temporary Barrier Notes
11	Pavement Markings

**GENERAL NOTES:**

- This Index contains information specific to the Federal and State guidelines and standards for the preparation of traffic control plans and for the execution of traffic control in work zones for construction and maintenance operations and utility work on highways, roads and streets on the State Highway System. Certain requirements in this Index are based on the high volume nature of State Highways. For highways, roads and streets off the State Highway System, the local agency (City/County) having jurisdiction may adopt requirements based on the minimum requirements provided in the MUTCD.
- Use this Index in accordance with the Plans and Indexes 102-601 through 102-680. Indexes 102-601 through 102-680 are Department-specific typical applications of commonly encountered situations. Adjust device location or number thereof as recommended by the Worksite Traffic Supervisor and approved by the Engineer. Devices include, but are not limited to, flaggers, portable temporary signals, signs, pavement markings, and channelizing devices. Comply with MUTCD or applicable Department criteria for any changes and document the reason for the change.
- Except for emergencies, any road closure on State Highway System must comply with Section 335.15, F.S.

**TABLE 1  
CHANNELIZING DEVICE SPACING**

Work Zone Speed (mph)	Max. Spacing (feet)			
	Cones or Temporary Tubular Markers		Type I Barricades, Type II Barricades, Vertical Panels, or Drums	
	Taper	Tangent	Taper	Tangent
≤ 45	25	50	25	50
≥ 50	25	50	50	100

**TABLE 2  
TAPER LENGTH "L"**

Work Zone Speed (mph)	Min. Length (feet)
≤ 40	$L = \frac{WS^2}{60}$
≥ 45	$L = WS$

Where: W = width of offset in feet  
S = speed in mph

**TABLE 3  
WORK ZONE SIGN SPACING "X"**

Road Type	Min. Spacing (feet)
Arterials and Collectors with Work Zone Speed ≤ 40 mph	200
Arterials and Collectors with Work Zone Speed ≥ 45 mph	500
Limited Access Roadways *	1,500

\* For Limited access roadways with work zone speed ≤ 55 mph, the minimum spacing may be reduced in accordance with the MUTCD and as approved by the Engineer.

**TABLE 4  
BUFFER LENGTH "B"**

Work Zone Speed (mph)	Min. Length (feet)
25	155
30	200
35	250
40	305
45	360
50	425
55	495
60	570
65	645
70	730

Note: When Buffer Length "B" cannot be attained due to geometric constraints, use the greatest length possible, but not less than 155 feet.

**MARK MEYERS**

**Mark Meyers**

Certificate: 605769  
Has Completed a FDOT Approved Temporary Traffic Control: Advanced Course.

Issued: 02/13/2023 Training Provider: myTTConline  
Expires: 02/02/2027 83 Geneva Dr. Ste. 621394 Oviedo, FL 32762 Ph: 407-901-0206

Instructor: M.H

Verify this Certificate at [www.motadmin.com](http://www.motadmin.com)

LAST REVISION	DESCRIPTION:
11/01/20	

**FY 2023-24  
STANDARD PLANS**

**GENERAL INFORMATION FOR TRAFFIC CONTROL THROUGH WORK ZONES**

INDEX	SHEET
102-600	1 of 11

9/23/2021 2:46:07 PM



## Notes for Figure 6H-20—Typical Application 20 Detour for a Closed Street

**Guidance:**

1. *This plan should be used for streets without posted route numbers.*
2. *On multi-lane streets, Detour signs with an Advance Turn Arrow should be used in advance of a turn.*

**Option:**

3. Flashing warning lights and/or flags may be used to call attention to the advance warning signs.
4. Flashing warning lights may be used on Type 3 Barricades.
5. Detour signs may be located on the far side of intersections. A Detour sign with an advance arrow may be used in advance of a turn.
6. A Street Name sign may be mounted with the Detour sign. The Street Name sign may be either white on green or black on orange.

**Standard:**

7. **When used, the Street Name sign shall be placed above the Detour sign.**

**Support:**

8. See Figure 6H-9 for the information for detouring a numbered highway.



MARK MEYERS

	Mark Meyers
Certificate: <b>605769</b>	Has Completed a FDOT Approved Temporary Traffic Control: Advanced Course.
Issued: 02/13/2023	Training Provider: myTTConline
Expires: 02/02/2027	83 Geneva Dr, Ste. 621394 Oviedo, FL 32762
Instructor: M.H	Ph: 407-901-0206
Verify this Certificate at <a href="http://www.motadmin.com">www.motadmin.com</a> .	



Figure 6H-20. Detour for a Closed Street (TA-20)

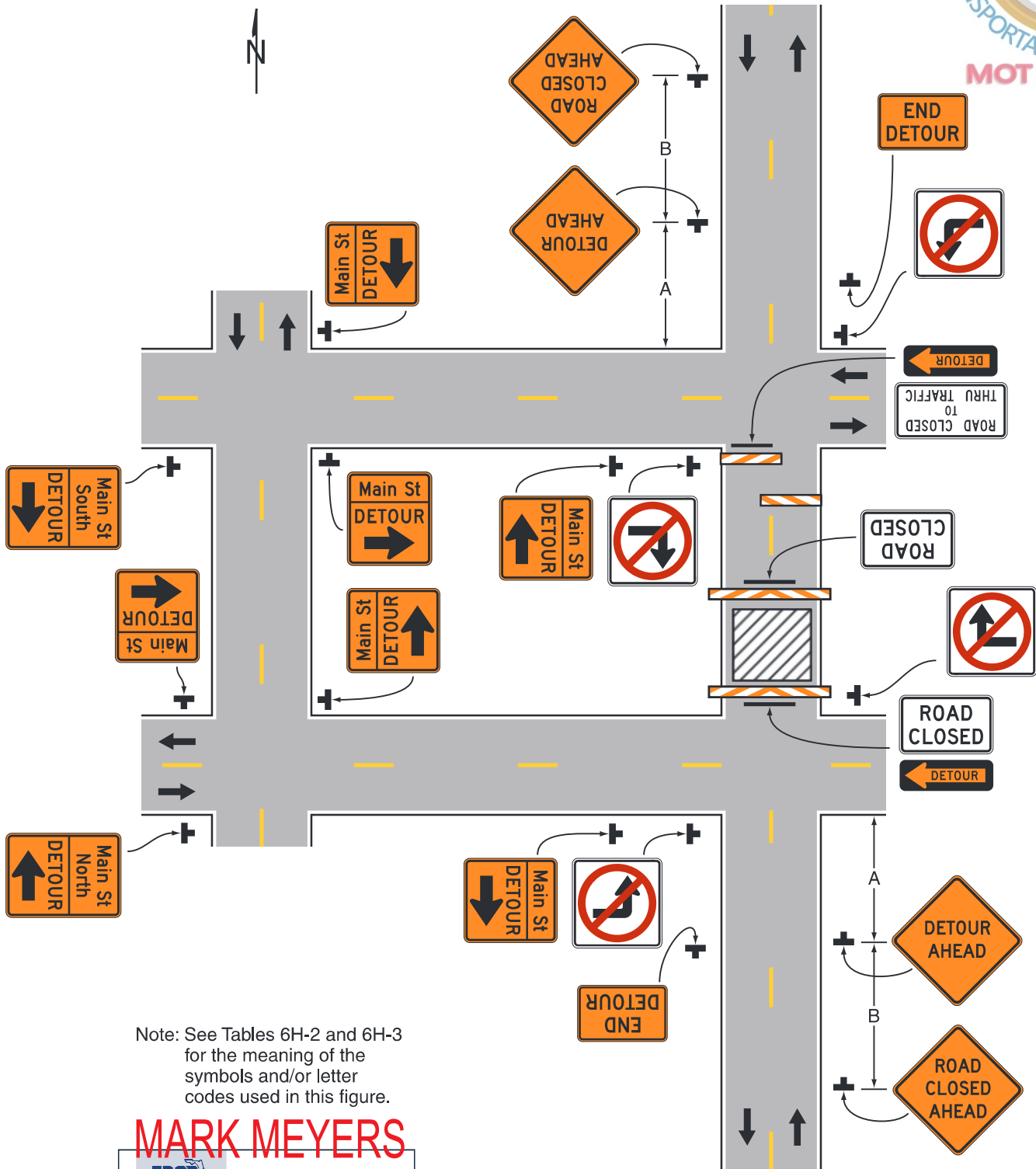

Note: See Tables 6H-2 and 6H-3 for the meaning of the symbols and/or letter codes used in this figure.

**MARK MEYERS**





	Mark Meyers
Certificate: 605769	Has Completed a FDOT Approved Temporary Traffic Control: Advanced Course.
Issued: 02/13/2023	Training Provider: myTTOnline
Expires: 02/02/2027	83 Geneva Dr. Ste. 621394 Oviedo, FL 32762
Instructor: M. H.	Ph: 407-901-0206
Verify this Certificate at <a href="http://www.motadmin.com">www.motadmin.com</a> .	

**Typical Application 20**

**NOTES:**

1. Cover or deactivate pedestrian traffic signal display(s) controlling closed crosswalks.
2. Place pedestrian LCDs across the full width of the closed sidewalk.
3. For post mounted signs located near or adjacent to a sidewalk, maintain a minimum 7" clearance from the bottom of the sign panel to the surface of the sidewalk.
4. "Sidewalk Closed" signs (R9-XX) may be mounted on pedestrian LCDs in accordance with the manufacturer's instructions.
5. Omit the Advance Closure LCD if it blocks access to other pedestrian facilities (e.g., transit stops, residences, or business entrances).

**SYMBOLS:**

-  Work Area
-  Work Zone Sign
-  Pedestrian Longitudinal Channelizing Device (LCD)
-  Lane Identification and Direction of Traffic

**MARK MEYERS**

	<b>Mark Meyers</b>
Certificate: <b>605769</b>	Has Completed a FDOT Approved Temporary Traffic Control Advanced Course.
Issued: 02/13/2023 Training Provider:	myTTOnline 83 Geneva Dr. Ste. 621394 Oviedo, FL 32762
Expires: 02/02/2027	myTTonline Ph: 407-901-0206
Instructor: M.H	Verify this Certificate at <a href="http://www.motadmin.com">www.motadmin.com</a> .

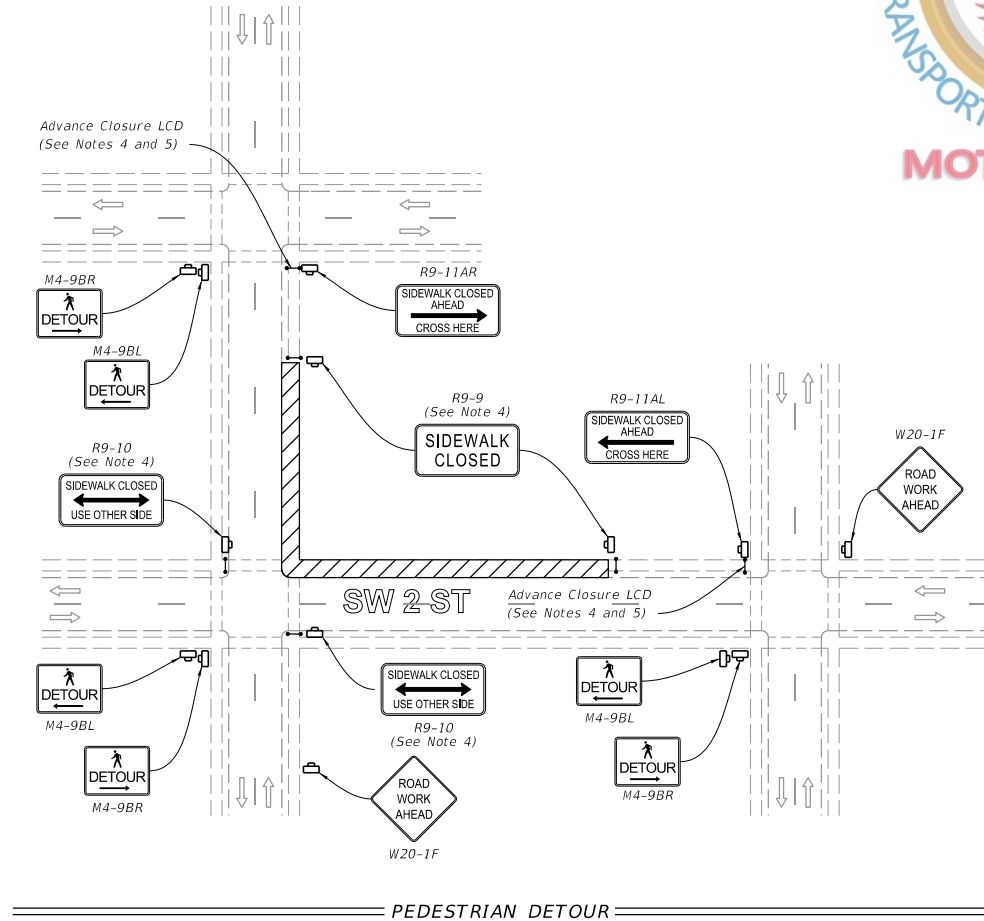

PEDESTRIAN DETOUR

10/6/2022 1:28:35 PM

LAST REVISION 11/01/20	DESCRIPTION:	 <b>FY 2023-24 STANDARD PLANS</b>	<b>SIDEWALK CLOSURE</b>	INDEX 102-660	SHEET 1 of 2
---------------------------	--------------	--	-------------------------	------------------	-----------------