







Case Number: R18028

**DEDICATION OF RIGHTS-OF-WAY:** Per ULDR Section 47-25.2.M.5, property shall be conveyed to the public by plat, deed or grant of easement as needed in accordance with the Broward County Trafficways Plan, the city's comprehensive plan, subdivision regulations and accepted applicable traffic engineering standards:

- a. Provide 5' Right-of-Way dedication or permanent Right-of-Way Easement along west side of NW 23<sup>rd</sup> Avenue (coordinate with BCHCED), to complete half of 80' Right-of-Way section per the most current Broward County Trafficways Plan; show / label delineation in the plans. Clarify with BCHCED if Right-of-Way dedication (which may affect building setbacks) or Right-of-Way Easement (which doesn't affect building setbacks) will be required.
- b. Provide 25' corner chord Right-of-Way dedication or permanent Right-of-Way Easement on southwest corner of NW 23<sup>rd</sup> Avenue & NW 16<sup>th</sup> Street intersection (coordinate with BCHCED) per ULDR Section 47-24.5.D.p; show / label delineation in the plans. Clarify with BCHCED if Right-of-Way dedication or Right-of-Way Easement will be required.
- c. Provide 20' corner chord permanent Right-of-Way Easement on southeast corner of NW 16<sup>th</sup> Street & NW 24<sup>th</sup> Avenue intersection per ULDR Section 47-24.5.D.p; show / label delineation in the plans.
- d. Provide permanent Sidewalk Easement as appropriate along south side of NW 16<sup>th</sup> Street to accommodate portion of pedestrian clear path (coordinate required width with TAM) that may be located beyond public Right-of-Way; show / label delineation in the plans.
- e. Provide permanent Sidewalk Easement as appropriate along east side of NW 24<sup>th</sup> Avenue to accommodate portion of pedestrian clear path (coordinate required width with TAM) that may be located beyond public Right-of-Way; show / label delineation in the plans.
- f. Provide 10' x 15' (min.) permanent Utility Easement for any 4 Inch or larger water meter and/or the first private sanitary sewer manhole located within the proposed development (for City Maintenance access); show / label delineation in the plans as appropriate.

**CASE COMMENTS:**

**Prior to Final DRC sign-off, please provide updated plans and written response to the following review comments:**

1. Meet the City's Adequacy requirements to services provided to the public (fire service, water, wastewater, stormwater, transportation, etc.), per ULDR Section 47-25.2 of the City's Code of Ordinances. Assess potential demands and impacts on City services and prepare a design for each that utilizes existing water, wastewater, stormwater, and transportation infrastructure to adequately serve this project. If the adequate infrastructure is not available, prepare a design that extends/expands the connection to the nearest City system to adequately serve this development.
  - a. Prepare service demand calculations for water & wastewater services and obtain a letter of service availability from the City's Public Works – Engineering Department. Please contact Rohan Punit at 954-828-5859 or [rpunit@fortlauderdale.gov](mailto:rpunit@fortlauderdale.gov).
2. Provide spot elevations along east and south property boundaries (50' min. interval).
3. Provide and label typical roadway cross-sections for the proposed development side of NW 23<sup>rd</sup> Avenue, NW 16<sup>th</sup> Street, and NW 24<sup>th</sup> Avenue: at driveway access points, at on-street parallel parking lanes, and at landscape swale areas (i.e. between travel lane and sidewalk) as appropriate. Coordinate with TAM the required minimum travel lane widths for City streets adjacent to the proposed development.





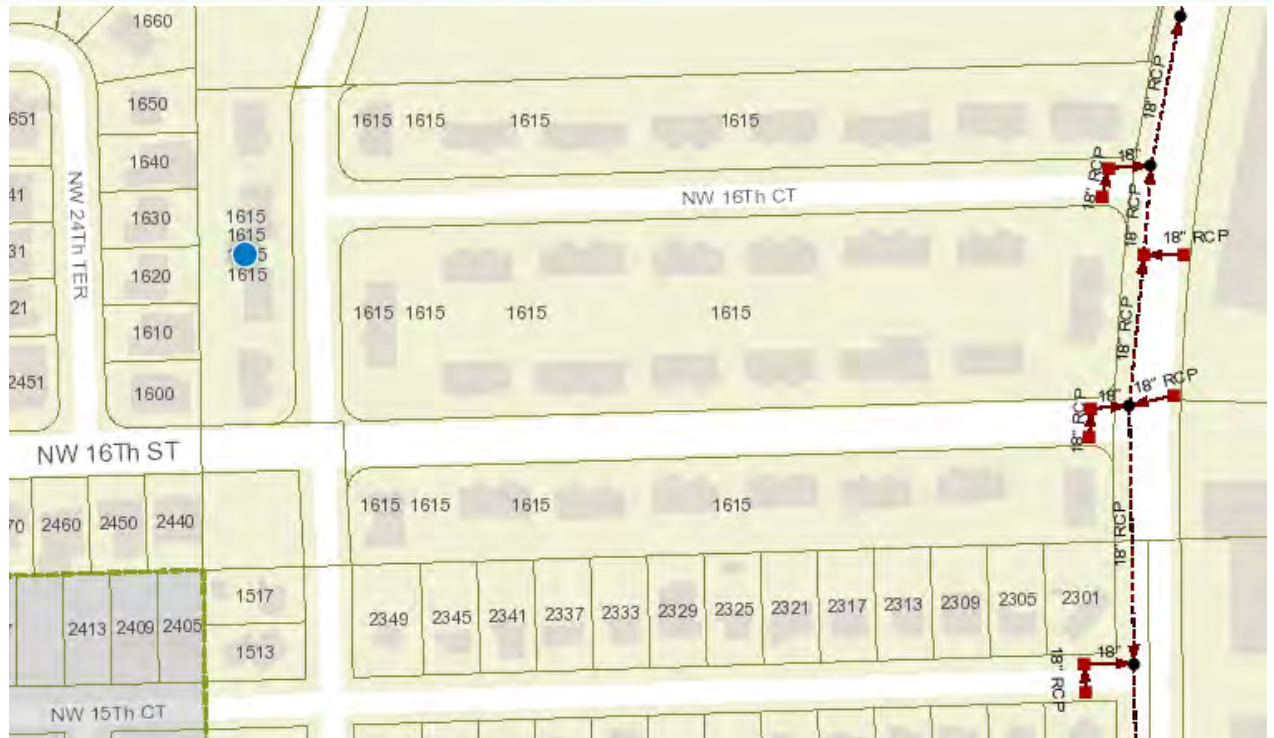

15. Please see Attachment 'A' for General Advisory Information (Engineering).



Case Number: R18028

**ATTACHMENT 'A' - GENERAL ADVISORY INFORMATION (ENGINEERING):**

- A. All proposed improvements within or adjacent to the Florida Department of Transportation (FDOT), Broward County Highway Construction & Engineering Division (BCHCED), and City Right-of-Way are subject to issuance of a Right-of-Way permit from the authority having jurisdiction. This shall include the execution of an agreement that authorizes those entities for removing the improvements for any public purpose in the future. The Applicant shall also execute a maintenance agreement with the appropriate FDOT, BCHCED, and City entities attesting that all improvements, including asphalt paving, concrete sidewalks, curb & gutter, specialty hardscaping, landscaping, irrigation, lighting, etc., proposed within the adjacent public Right-of-Way (between Right-of-Way boundary and street pavement edge) will be maintained by the Applicant throughout the life of the improvements.

Applicant shall not connect the on-site drainage system to those within the adjacent public Right-of-Ways of FDOT, BCHCED, and the City of Fort Lauderdale.

Please note that all easements and maintenance agreements shall be recorded prior to final permit close out and Certificate of Occupancy issuance.

- B. Please be advised that if Right-of-Way dedications and/or Right-of-Way Easements (per the Broward County Trafficways Plan), including corner chords (per ULDR Section 47-24.5.D.1.p.vi), are waived by FDOT and/or BCHCED (provide written correspondence), they will still be requested by the City of Fort of Fort Lauderdale.
- C. Prepare and submit the following Civil Engineering drawings as part of DRC submittal, signed and sealed by a Florida registered professional Civil Engineer:
- 1) Paving, Grading, and Drainage Plan, including any existing public storm drain infrastructure adjacent to the proposed development (show all pipe materials and sizes on the plan) to demonstrate how stormwater runoff will remain onsite (provide sufficient spot elevations around building footprint, landscape areas, and property lines). Please be advised that all proposed storm drains with City Right-of-Way shall be constructed with Reinforced Concrete Pipe (RCP).
  - 2) Water and Sewer Plan, including any existing water mains, force mains, gravity mains, etc. (show all pipe materials & sizes on the plan). Please be advised that all proposed water mains constructed within City Right-of-Way shall be Ductile Iron Pipe (DIP).
  - 3) Erosion and Sediment Control Plan, to be reviewed for the drainage impacts to adjacent properties, surrounding Right-of-Way, stormwater facilities, and neighboring water bodies. Please be advised that proposed silt fence taller than 30" is not allowed within sight triangles.
  - 4) Signing and Marking Plan, including details, and label radii of all landscaping and pavement areas.
  - 5) Provide typical cross-sections along all property lines, including at driveway access points, at on-street parallel parking lanes, and at landscape areas as appropriate. Show how the existing and proposed grades will tie to one another, and how stormwater runoff will remain onsite. Also, show spot elevations along the perimeter (property lines) on the Paving, Grading, and Drainage Plan.
- D. Please be advised that the Public Works water & wastewater capacity allocation is valid up until the first extension request after Final DRC approval (i.e. 18 months to apply for construction permit and 24 months for issuance of building permit). After that, the developer must obtain an updated letter of service availability from the City's Public Works – Engineering Department.



- E. All existing driveways (accessing City Right-of-Way) not being utilized by the proposed development shall be fully removed and areas restored as appropriate.
- F. Per ULDR Section 47-19.4.D.6, all dumpster enclosures and adjacent service access drive shall be placed on poured concrete, solid or perforated interlocking concrete block paving (ICB), or any existing hardened paving system; in cases where a hard surface or drive which is adequate to support the combined full weight of the bulk container, the enclosure and service vehicles does not exist, a 10' wide hard surface extension directly in front of the bulk container shall be required for purposes of emptying the container.
- G. Provide ADA accessibility, required within public Right-of-Way and areas of public accommodation within private property, in accordance with Chapter 553 of the Florida's Statutes, "Accessibility of Handicapped Persons " and latest edition of "Accessibility Requirements Manual" by Department of Community Affairs Florida Board of Building Codes and Standard and in accordance with American Disability Act (ADA).

Final construction checklist item shall include Engineer of Record (EOR) inspection of ADA accessible route(s) for the proposed development, and have necessary repairs made as appropriate.

- H. EOR to perform due diligence to field verify all existing utilities (including those shown in City Utility Atlas Maps); coordinate with franchise utility owner for required undergrounding of overhead lines, and provide routing layout on Civil and Landscape plans as appropriate.
- I. Provide Demolition and Utility Disposition Plan for any existing building structures, paved areas, walls, underground utilities, etc.
- J. Provide Utility Connection Plan for all franchise utilities, such as AT&T, Comcast, FP&L, Teco, etc.
- K. Please be advised that Drainage Well, Backflow Preventer, etc. assemblies shall be located within proposed development, and not within the City's Right-of-Way or permanent easements; coordinate proposed location(s) within the respective FDOT and BCHCED jurisdictions as appropriate.
- L. Any road cuts for utilities or curb cuts within in the City Right-of-Way shall be restored to full lane width for 50' minimum length, per City Code of Ordinances Section 25-108; show and label in plans as appropriate. Verify with FDOT and/or BCHCED their requirements for any milling and asphalt pavement restoration in vicinity of proposed road cuts for utilities and/or curb cuts within their respective Right-of-Way jurisdictions.
- M. Prior to obtaining demolition permit, document with digital photos (including Key Map) and/or videos of the existing condition of the City's Right-of-Way adjacent to the proposed development. Current photos (not Google Street View images) and/or videos should include vantage points of the entire City Right-of-Way frontage adjacent to the proposed development, from both directions along City roadways and/or alleys, as well as of any other notable existing features.
- N. Submit the State of Florida Notice of Intent (FAC 62-621.300(4)(b)) per the Florida Department of Environmental Protection (FDEP) criteria. Notice is required for sites of one (1) acre or larger site area with the potential for discharge of sediments to surrounding surface waters or drainage systems which discharge indirectly to those surface waters as classified or otherwise identified in the Florida Administrative Code (FAC). Therefore, the Applicants whose projects disturb one or more acres of soil or whose projects disturb less than one acre but are part of a larger common plan of development that in total disturbs one or more acres, are required to obtain coverage under the General Permit for Discharges of Storm Water Associated with Construction Activity.





- O. Obtain a Transportation Concurrency Satisfaction Certificate from the Broward County Planning and Environmental Regulation Division (BCPERD). Please contact Howard Clarke at 954-357-5760 or [hoclarke@broward.org](mailto:hoclarke@broward.org) at BCPERD to determine whether the project is subject to the Transportation Concurrency Fees. In addition, please contact Pierre Dogniaux with the Broward County Transit Division at 954-357-8304 to determine what (if any) improvements are suggested to ensure mobility needs are adequately met for this proposed site.
- P. Obtain a general or surface water management license from the Broward County Environmental Protection & Growth Management Division (BCEPGMD). Route certified calculations with Paving & Drainage plans to the engineering reviewer.
- Q. Route and obtain approval from Broward County Traffic Engineering Division on any pavement marking and striping plans within City Right-of-Way.
- R. Verify the means for demolishing existing structures on the property so that appropriate timely notice and coordination can be executed with the City Public Works Utilities, and franchise utility companies to control impacts from the demolition. Please be advised that a permit is required for demolishing work activities.
- S. Prepare an appropriate staging plan, which includes phasing and information regarding the site layout of the temporary construction measures. The purpose of this plan is to identify the temporary construction measures that will be used to protect the general public, adjoining properties, and minimize the impact of the construction on neighboring transportation system, landscaping, Right-of-Way encroachments, and businesses. The items to be addressed by the staging plan shall include but not limited to the following:
  - 1) Submit a Construction Phasing Plan clearly depicting the phasing of construction if applicable. The plan shall show the following:
    - a. Include a narrative for each phase along with roadways utilized for materials delivery.
    - b. Clearly show boundaries of the site, dimensions, and names of all streets and alleys, direction of travel, bike lanes, on-street parking, and sidewalks.
    - c. Show location of Job trailers or construction offices for the staff, general contractor, and subcontractors with Finished Floor Elevations.
    - d. Show location, type, and size of temporary construction fencing, including locations of gates and gate swing radii. If corners of the fence correspond with cross streets, propose a fence boundary that will not obstruct sight lines for motor vehicles.
    - e. Show location and type of construction crane(s), including span radius.
    - f. Indicate location and number of portable restrooms, dumpsters, and trash chutes.
    - g. Show location of the Fire Department Connection during construction and a water supply (hydrant) in accordance with NF.P.A.1, Chapter 29.
    - h. Show location of any sidewalk to be closed or protected as required by Chapter 33 of the Florida Building Code.
    - i. Indicate location and time frame of any street closures (part or entire street) with a detour signage plan meeting MUTCD standards, prepared by a Certified Traffic engineer or technician. Please be advised that the City Commission approval will be required for detours and street and sidewalk closures lasting over 72 hours, and the said approval may take eight (8) weeks or more.
    - j. Show all existing parking spaces that may be affected by the construction (or construction phasing) and indicate all parking spaces that would be included within proposed construction boundaries for each phase.
    - k. Show location of parking for inspectors and construction personnel. Include all off-site parking – location, period of lease and number of spaces leased. If shuttle will be provided between parking and job site – give shuttle schedule and show the route of the shuttle.



- i. Show loading/unloading areas for material delivery to include entry and exit path of vehicles without backing into the street.
  - m. Show routes that delivery trucks will be instructed to follow when traveling to and from the site. All efforts should be made to avoid residential and/or small, merchant lined streets. This may be shown in a separate drawing, prepared at an appropriate scale in order to illustrate route through the City.
  - n. Indicate where and how concrete trucks will stage during multiple yardage pours.
  - o. Provide an Erosion Control Plan and show location and type of silt fencing for dust control along with measures for erosion control against material leaving the site from vehicular traffic.
  - p. Indicate the locations of storm inlets. If physical measures will be taken to protect inlets, illustrate these on the Erosion Control Plan.
  - q. Show locations of truck wash-off area and procedures, including tires and concrete chutes.
  - r. Indicate schedule for street sweeping of periphery of the construction site.
  - s. Indicate if dewatering is proposed.
- T. A dewatering permit from Broward County Environmental Protection Department (EPD) is required for sites within ¼ mile of a known contamination site. A map of contaminated sites can be found at <http://bcgis.maps.arcgis.com/apps/OnePane/basicviewer/index.html?appid=5d9ec5c1eb614c8b88d8990f48b15b7a#> or contact Norman Arrazola at [narrazola@broward.org](mailto:narrazola@broward.org) or 954-519-1237 to make this determination.
- U. Apply and obtain a South Florida Water Management District (SFWMD) dewatering permit activities if off-site discharge is anticipated. Any planned activity that requires dewatering needs to be reviewed by SFWMD. In many cases, this could involve an email to SFWMD that include a description of the activity. If no permit is required, SFWMD will let you know. The SFWMD contact person is Steve Memberg ([smemberg@sfwmd.gov](mailto:smemberg@sfwmd.gov)).
- V. Pay Capital Expansion Fees for water and wastewater treatment, distribution, and disposal at the rate identified in City Ordinance C-05-21. The fee will be calculated based on Equivalent Residential Connections (ERC's); provide a calculation for both existing and proposed ERC's as appropriate. Impact Fees shall be paid prior to the issuance of the building permit.
- W. Any lighting within the City's Right-of-Way shall be approved and authorized by the City's Engineering and /or Building (Electrical Staff) Department. Any lighting placed in the Right-of-Way shall be powered by an approved lighting circuit from the proposed development or FPL source and will require an engineering permit. Any new lighting system powered by private source shall require a Revocable License Agreement with the City along with a "disconnect" that shall be accessible by Facilities Maintenance staff in or near the Right-of-Way. Please contact the Facilities Maintenance Office, David Smith at 954-828-6560, for information concerning the lighting within the City's Right-of-Way.
- X. Obtain a franchise utility engineering permit before installing, removing, or relocating poles (lighting or electrical) within the City's Right-of-Way. Permanent or temporary relocations or removals shall be reviewed and approved by the City.
- Y. Please discuss locations/relocation of the underground utilities with the City Public Works Department - Utilities, Rick Johnson at 954-828-7809 or [rjohnson@fortlauderdale.gov](mailto:rjohnson@fortlauderdale.gov), as well as proposed methods of noise, vibration, and odor mitigation.
- Z. In order to help mitigate the possible impacts of the proposed development and/or construction activities to the existing condition of the City's stormwater assets, please provide (or revise if already submitted) an erosion, sedimentation, and Stormwater Pollution Prevention Plan (**SWPPP**) showing the



adjacent City's existing stormwater system as shown in the survey and Existing Stormwater Asset Map (green linework) provided in the DRC case comments. A copy of the approved SWPPP shall be at the construction site from the date of demolition initiation to the date of final construction activities.

Add the following notes to the **SWPPP** (CCTV Notes, Pollution Prevention Notes, and Dewatering Notes):

Closed Circuit TV inspection (CCTV) Notes (Applicable if dewatering to City stormwater assets)

- 1) Contractor shall provide CCTV videotapes to City STW OPS of the existing stormwater system to the limits shown in the Existing Stormwater Asset Map (green linework) provided in the DRC case comments, in order to document the PRE and POST construction conditions of the City's storm system.
- 2) Contractor shall provide the PRE construction CCTV to City STW OPS when applying for a demolition permit at the City's building department.
  - a. If debris is found in the City's stormwater system prior to demolition or construction, the applicant, contractor, developer or designer (as applicable) shall inform the City's stormwater operations department for proper removal.
- 3) Contractor shall provide the POST construction videotape to City STW OPS when requesting the Certificate of Occupancy (CO) to verify that the City's stormwater systems have not been negatively impacted by the demolition and construction activities.
  - a. If debris is found in the City's storm systems as a result of demolition or construction activities, it will be the responsibility of the contractor to vacuum clean the City's stormwater system (or make repairs as requested by City's stormwater operations group) prior to issuance of final CO.
  - b. If surface water runoff or debris from demolition or construction activities is found to have negatively impacted the condition of the City's stormwater assets, it will be the responsibility of the applicant (contractor, developer, and owner) to rectify the infraction(s) as requested by City.

Pollution Prevention Notes (Applicable to all site developments)

- 4) Contractor shall adhere to of the National Pollution Discharge Elimination System (NPDES) requirements. The contractor shall institute Best Management Practices (BMPs) to ensure compliance with the NPDES program and to minimize the impact to public stormwater facilities. A Notice of Intent (NOI) shall be filed prior to start construction activities.
- 5) Prior to demolition activities, contractor shall install pollution prevention control devices (i.e., silt barriers, sediment basins, turbidity barriers around stormwater outfalls on the waterside of lakes, ponds, canals, or waterways, silt screens, etc. according to the approved SWPPP and as recommended by the Florida Department of Environmental Protection (DEP) latest guidelines and permitting requirements.
- 6) Prior to demolition activities, a silt fence in accordance with the approved SWPPP details and latest DEP standards shall be erected around the site property lines. All public inlets surrounding the site shall be protected by the installation of filter fabric into the frame and grate or other approved BMPs to protect against storm runoff.
- 7) Pollution control installations, as approved and shown in the SWPPP, shall be maintained throughout demolition and construction periods until the project has been completed and approved by City engineering inspector or project engineer.
- 8) Contractor shall inspect the pollution control devices daily for signs of malfunction, failure, or needed repairs, and shall make remedial actions immediately upon discovery.
- 9) Existing stormwater inlets, catch basins, or manholes, onsite and offsite, shall be protected from sediment storm runoff from the proposed demolitions and construction activities.



- 10) Contractor shall immediately remove all mud, dirt, or other materials tracked or spilled onto existing roads and facilities due to demolition or construction activities from the proposed development.
- 11) In order to minimize the amount of sediments, mud, and dust transported onto public roadways by the construction vehicles or runoff, the contractor shall install stabilized temporary construction entrance(s) from the construction site as recommended by FDEP. Each temporary construction entrance is a stabilized 6 inch thick layer of 2 to 3 inch Course Aggregate Stone, 12" minimum width, and length to accommodate a minimum of one trucking vehicle.
  - a. The entrance shall be maintained periodically as conditions demand in a condition that will prevent tracking or flowing of sediments onto public rights-of-way. Sediment shall be trapped in cleanout areas and properly handled as onsite debris per applicable state regulations.
  - b. When necessary, vehicle wheels shall be cleaned prior to entrance onto public right-of-way.
  - c. All materials spilled, dropped, washed or tracked from vehicles onto roadways or into public storm drains must be removed by the contractor immediately.
  - d. Trucks shall not 'cut corners' where the construction exit meets the roadways.
  - e. Sweeping of public roadways shall be done periodically as condition demand.
- 12) Dust generated from construction shall be minimized by daily watering of the site.
- 13) Contractor shall provide an erosion and sedimentation control inspector to inspect all points of discharge into nearby waterbodies to record the condition of discharge points, integrity of silt fence and pollution control devices, dust control measures, vehicular traffic and construction material storage and disposal. Written record of all inspections shall be stored by the contractor during demolition and construction periods and shall be submitted to City inspectors upon request.

The inspection report shall include at a minimum the following information:

- a. Name of inspector and his/her qualifications in erosion and sedimentation control.
- b. Date of the inspection.
- c. Rainfall rate.
- d. Observations about the SWPP.
- e. Actions taken by contractor for all incidents of noncompliance with permit(s).
- f. Certification that the facility is in compliance with the SWPP and permit(s).

**Dewatering Notes (Applicable if dewatering activities are anticipated)**

- 14) The applicant shall use Broward County's latest [Plate WM 2.1 - Future Conditions](#) for determining the average wet season ground water levels to evaluate if demolition or excavation/earthwork will require dewatering activities. The Plate WM 2.1 – Future Conditions average wet season ground water levels can be accessed through the following link:  
<http://bcgis.maps.arcgis.com/apps/View/index.html?appid=70c3f3ffc88748c28e432719ec2844c4>
- 15) If dewatering activities are anticipated, a notarized City dewatering affidavit shall be filed at City's building department when submitting a demolition or foundation permit along with any applicable dewatering permit form regulatory agencies such as the South Florida Water Management District or Broward County Department of Environmental Protection.
- 16) If dewatering is going to be needed, please submit a dewatering plan, so it can be reviewed by the City's stormwater and environmental groups.
- 17) Dewatering activities will not be allowed without an approved dewatering affidavit, SWPPP, and dewatering permit from applicable regulatory agencies.



Case Number: R18028

**CASE COMMENTS:**

Please provide a response to the following:

1. Building needs to conform to section 903.2.11.3.1 of the FBC for fire sprinklers.
2. Fire hydrant location must be with-in 100 feet of FDC.

**GENERAL COMMENTS**

The following comments are for informational purposes.

Please consider the following prior to submittal for Final DRC:

- 1.

Please consider the following prior to submittal for Building Permit:

1. Building must conform to the code applicable at time of submittal.



Case Number: R18028

**CASE COMMENTS:**

Please provide a response to the following:

1. The City has adopted Florida Friendly Landscaping requirements into our ULDR Section 47-21. This basically means that plant material must be grouped together based on watering needs, and turf areas must be limited and/or consolidated. The planting areas are to be irrigated on a separate zone than the turf areas. Once plants are established, that particular zone can be shut off based on the season. The overall goal is to decrease water use through irrigation. Illustrate the hydrozone and provide calculations.
2. Shift sidewalk in towards the property line along 23 Ave to increase the landscape area between the travel lane and the pedestrian areas.
3. Provide street trees in the right of way swale area, as per ULDR 47-21.13.B.16 (for example 23 Ave). Street trees are to be a minimum of 12 feet tall and provided at a ratio of one street tree per forty feet of street frontage or greater fraction thereof not subtracting ingress and egress dimensions. When overhead utilities exist, required street trees may be small trees provided at a minimum of a ratio of one street tree per twenty feet frontage or greater fraction thereof not subtracting ingress and egress dimensions.
4. Reduce driveway widths to 20' (except where adjacent to back out parking) to increase landscaped pervious area.
5. The use of structural soil is required in paved sites to provide adequate soil volumes for tree roots under pavements, as per ULDR Section 47-21.13. Structural soil details and specifications can be obtained at <http://www.hort.cornell.edu/uhi/outreach/index.htm#soil> This is to be provided at a minimum of 8' radii of tree trunks, and is to be consistently illustrated and noted on landscape, site and civil plans.
6. Utilities and site amenities such as walkways, flagpoles, transformers, fire hydrants, sewer and water supply lines, trash enclosures, and similar items located on the site shall not be placed in or under required tree planting areas, as per ULDR Section 47-21.12. Confirm with civil, site and life safety plans that utilities and site amenities are not causing conflicts with proposed landscaping. Where conflicts exist, shift the utility and/or site amenities.
7. Light fixtures with an overall height of more than ten feet shall be located a minimum of 15 feet away from shade trees, as per ULDR Section 47-21.12.
8. As with Block 1 review, staff inspected the site and the condition percentages of several existing trees appear to be low, thus shifting several trees to specimen status. Provide arborist report documenting method used for each canopy tree condition rating. This should be on ISA Certified Arborist business letterhead with contact information and ISA Certification number clearly stated. This report would include tree survey with numbered trees, a corresponding table which includes tree number, botanical name and common name, trunk diameter at breast height, condition percentage and method used, and a written assessment of existing tree characteristics supporting the condition rating and downgrading factors.



9. Consider relocating trees to the right-of-way, on-site, and/or city parks.
10. Label the existing trees on sheet LP-1 with same numbers from sheet TS-1.
11. Provide, in tabular format, all required versus provided landscape calculations. Review landscape plan requirements for data to be included on plans, as per ULDR Section 47-21.6.
12. Provide clusters of 3 single Veitchia palms instead of one triple plant.
13. Not more than 40% of landscaped pervious area can be turf. Illustrate this and provide the calculation.
14. The zoning of this property requires at least one tree for each 1,000 square feet of net lot area or portion thereof, as per ULDR 47-21.13.A&B. This tree planting requirement is in addition to the VUA landscaping requirements. Twenty percent of the trees shall be shade trees. Please illustrate the calculations and planting on plan.
15. The zoning of this property requires at least twelve ornamental shrubs for each 1,000 square feet of net lot area or portion thereof, as per ULDR 47-21.13.A&B. Shrub planting requirements are in addition to the VUA requirements. At least 50 percent of all required shrubs shall consist of native species. Please illustrate the calculations and planting on plan.
16. The zoning of this property requires a minimum of 35 percent of the gross lot square footage shall be in landscaping, maintained by an irrigation system, as per ULDR 47-21.13.A&B. The minimum twenty percent VUA required landscaping may be used toward fulfilling the gross thirty-five percent minimum. Sandy beach on oceanfront parcels of land may be included in the gross minimum, but do not need to be planted or irrigated.

### **General Comments**

#### **Please consider the following prior to submittal for Building Permit:**

17. Separate sub-permit applications for Tree Removal & Relocation and General Landscaping for site are required at time of master permit submittal.
18. Provide separate Plumbing sub permit application for irrigation. Irrigation plans are required at time of Building permit submittal. Plans are to be in compliance with ULDR 47-21.6.A.11 and 47-21.10.
19. Note that tree removal at time of demolition will not be permitted unless the Master Permit for redevelopment has been submitted for review.



**Case Number: R18028**

**CASE COMMENTS:**

Please provide a response to the following:

1. Entry doors should be solid, impact resistant or metal.
2. Residential units entry doors should be equipped with a quality secondary deadbolt locking system and have a 180 degree peephole or view port for security.
3. Sliding glass doors and sliding glass windows should be equipped with burglary deterrent features such as track blocks, door pins or deadbolts. The door should also provide features to prevent the doors from being lifted off track.
4. All glazing should be impact resistant.
5. Units should be pre-wired for an alarm system.
6. A Closed Circuit TV system capable of retrieving an identifiable image of an individual should be used throughout the site including coverage of parking lots and activity generation areas.
7. Lighting and landscaping should follow C.P.T.E.D. guidelines.

**GENERAL COMMENTS**

It is highly recommended that the managing company make arrangements for private security during construction.

Please submit responses in writing prior to DRC sign off.





Case Number: R18028

**CASE COMMENTS:**

Please provide a response to the following:

1. Garbage, Recycling and Bulk Trash shall be provided.
2. Recycling reduces the amount of trash your business creates and it is the best way to reduce monthly waste disposal costs and improve your company's bottom line.
3. Solid Waste Services shall be provided by a Private Contractor licensed by the City.
4. Service Days shall be: No restriction for Commercial collection. Service may not occur earlier than 7:00 am or later than 10:00 pm within 250 feet of residential.
5. Solid Waste Collection shall be on private property container shall not be placed, stored or block the public street to perform service (large multifamily and commercial parcels).
6. Containers: must comply with 47-19.4
7. Dumpster enclosure: concrete pad, decorative block wall, gates hung independently, protective bollards, secondary pedestrian side entry, high strengthen apron and driveway approach, night light, hot water, hose bib, drain, low circulating ventilation for dampness, weep holes, landscaping, smooth surface walkway to accommodate wheeled containers.
8. Provide on the site plan a garbage truck turning radii for City review. Indicate how truck will circulate within property.
9. Submit a Solid Waste Management Plan on your letterhead containing name of project, address, DRC case number, number of units if applicable, and indicate whether it is Pre or Final DRC.
  - o This letter is to be approved and signed off by the Sustainability Division, and should be attached to your drawings. Please email an electronic copy to [smccutcheon@fortlauderdale.gov](mailto:smccutcheon@fortlauderdale.gov). Letter should include an analysis of the expected amounts of solid waste and recyclables that will be generated (if different from current capacity), and container requirements to meet proposed capacity.
  - o Community Inspections will reference this Solid Waste Plan for sanitation compliance issues at this location.

**GENERAL COMMENTS**

The following comments are for informational purposes.

Please consider the following prior to submittal for Final DRC:

1. None



Case Number: R18028

**CASE COMMENTS:**

1. Revise the traffic impact statement with the latest ITE trip generation manual 10<sup>th</sup> edition and show daily, AM peak, and PM peak trip generations. Also include the equations that were used in the traffic impact statement. Coordinate with the Transportation and Mobility Department regarding traffic calming and a traffic impact study if needed. Take into consideration that the review of this study, once submitted, will take about 4-6 weeks.
2. Continue coordination with Transportation and Mobility regarding the parking reduction request.
3. Street trees must be a minimum 6 feet from the edge of pavement where curb is not provided.
4. Provide pedestrian lighting along sidewalks.
5. Continue concrete sidewalk through the driveways.
6. Provide Brasco Interlude bus shelters and landing pads at the bus stop locations along the site.
7. This area has been recognized as a high crash area, traffic calming will be needed. Possible options for traffic calming enhancements at the intersections could be raised intersections, roundabouts, high emphasize crosswalks etc.
8. City has the right to meter on street parking in the public right of way at any time.
9. There must be a minimum of 22 feet from the driveways ultimate right of way line to the first conflict point. Please ensure this requirement is met.
10. Provide and label FDOT sight triangle (per the most current FDOT Design Standards) on the Site Plan, Landscape Plan, and Civil Plans.
11. Per ULDR Section 47-2.2.Q, show and label sight triangles as appropriate for safe and adequate access of drivers and pedestrians, on the Site Plan, Landscape Plans, and Civil Plans: intersections of driveways with streets and alleys (10' measured from intersection point of pavement edges), alleys with alleys (15' measured from intersection point of extended property lines), alleys with streets (15' measured from intersection point of extended property lines), and streets with streets (25' measured from intersection point of extended property lines). The request for reduction of sight triangle dimensions is subject to review by the City Engineer on a case-by-case basis. Per ULDR Section 47-19.1.E, no accessory use or structure shall be permitted within a sight triangle except as provided in ULDR Section 47-35.
12. Show all sidewalk dimensions on the site plan, including all pinch points on the site.
13. Bicycle parking is needed, covered if possible, with a bike pump. Consult the APBP Bicycle Parking Guidelines and Broward County End-of-Trip Bicycle Facilities Guide. Provide the minimum long term and short term bicycle parking based on requirements in the guide and include total counts on the site plan data sheet.



14. Please consider enhancing the pedestrian experience by providing interactive public art works, seating, and shade along all sidewalks to promote multimodal travel.
15. Ensure all access points, sidewalks, walkways, and curb cuts are unobstructed and ADA accessible with appropriate slopes and detectible warning devices and indicate on the site plan.
16. Additional comments may be provided upon further review.
17. Signature required.

**GENERAL COMMENTS:**

Please address comments below where applicable.

1. Contact Benjamin Restrepo at 954-828-5216 or brestrepo@fortlauderdale.gov to set up an appointment for final plan approval.
2. The City's Transportation & Mobility Department encourages the use of sustainable materials such as permeable pavement and electric car charge stations and installation of multimodal facilities such as bicycle pump stations and bike lockers.
3. Please note that any work within the City's right-of-way will require an MOT approved by Transportation and Mobility and Engineering for permitting. Any full closures of roadways, alleys, or sidewalks that are over 72 hours will require a Revocable License Agreement (RLA) with the City of Fort Lauderdale.

**Case Number: R18028**

- 1) The applicant is strongly encouraged to contact neighbors adjacent to, as well as condominium and neighborhood associations located within three hundred feet (300') of the development site, to advise of this proposal (a listing of officially-recognized neighborhood associations is provided on the City's website: <http://www.fortlauderdale.gov/neighbors/civic-associations> and a map of neighborhood associations may be found at: <http://gis.fortlauderdale.gov>). Please provide acknowledgement and/or documentation of any public outreach.
- 2) The site is designated Medium Residential on the City's Future Land Use Map. The proposed use is permitted in these designations. This is not a determination on consistency with Comprehensive Plan Goals, Objectives and Policies.
- 3) Verify that copy of plat is the most current recorded plat, including notes and amendments, for the proposed site. Provide documentation from the Broward County Planning Council verifying that the site does not require platting or replatting. If replatting or platting is not required, contact the Development Review Services Section of the Planning and Environmental Regulation Division of Broward County at (954) 357-6637 to ensure that proposed project is consistent with the latest recorded plat restriction.
- 4) It appears that there is insufficient on-site parking for the development. A separate application and fee is required for a parking reduction. Should the application for a parking reduction be approved, a parking reduction order must be executed and recorded in the public records of Broward County at the applicant's expense, prior to Final DRC approval.
- 5) Provide the zoning designation lines on the Overall Site Plan sheet.
- 6) Provide the following changes on site plan:
  - a) Provide a new 5' wide sidewalk and it should be separated from the right-of-way along NW 23<sup>rd</sup> Avenue with adequate landscaping. Please coordinate with the Landscape Plan Reviewer, Kim Pearson. This will create a safe, comfortable pedestrian environment along the ROW.
  - b) Indicate location of all mechanical equipment on the Site Plan sheet.
- 7) Consider adding balconies, arcades, terracing to the elevations, to add interest to the facades as well as provide protection from the elements. Clearly depict metal canopy on elevations and provide dimensions from building façade.
- 8) Include elevations for all building facades.
- 9) Provide photometric plan, showing foot-candle readings extended to all property lines. Provide pedestrian lighting.
- 10) Provide number of residential units currently on-site be aware that you should receive building impact fee credits for the existing units on the property.
- 11) This project is subject to the requirements of Broward County Public School Concurrency. The applicant will notify the School Board Superintendent or designee of this proposal. Prior to submitting an application for placement on a Planning and Zoning Board or City Commission agenda, a written response from the School Board shall be provided by the applicant. Prior to application for final DRC approval, please provide confirmation from the School District that the residential development is exempt or vested from the requirements of public school concurrency, or a School Capacity Availability Determination (SCAD) letter that confirms that capacity is available, or if capacity is not available, that mitigation requirements have been satisfied.



- 12) Please provide total park impact fee amount due. Park impact fees are assessed and collected at time of permit per each new hotel room and dwelling unit type. An impact fee calculator can be found at: <http://www.fortlauderdale.gov/departments/sustainable-development/building-services/permit-fees/park-impact-fee-calculator>

#### **GENERAL COMMENTS**

The following comments are for informational purposes:

- 13) If a temporary construction/sales trailer is needed for this project, provide the details and location of the trailer on a separate site plan, to avoid additional review in the future. Verify details and location with the Building Representative.
- 14) An additional follow-up coordination meeting may be required to review project changes necessitated by the DRC comments. Prior to routing your plans for Final DRC sign-off, please schedule an appointment with the project planner, Yvonne Redding, (call 954-828-6495) to review project revisions and/or to obtain a signature routing stamp. Please note applicant is responsible for obtaining signatures from all discipline members that had comments and may need to resolve comments through individual appointments if necessary.
- 15) For additional information regarding incorporation of wireless capabilities into the project in initial planning stages, please contact the applicable utility provider.
- 16) All construction activity must comply with ULDR, Section 24-11, Construction sites. Contact Joe Pasquariello, Structural Plans Examiner (954-828-5419) to obtain his signature on the final DRC plans.
- 17) Additional comments may be forthcoming at the DRC meeting. Please provide a written response to all DRC comments within 180 days.

